

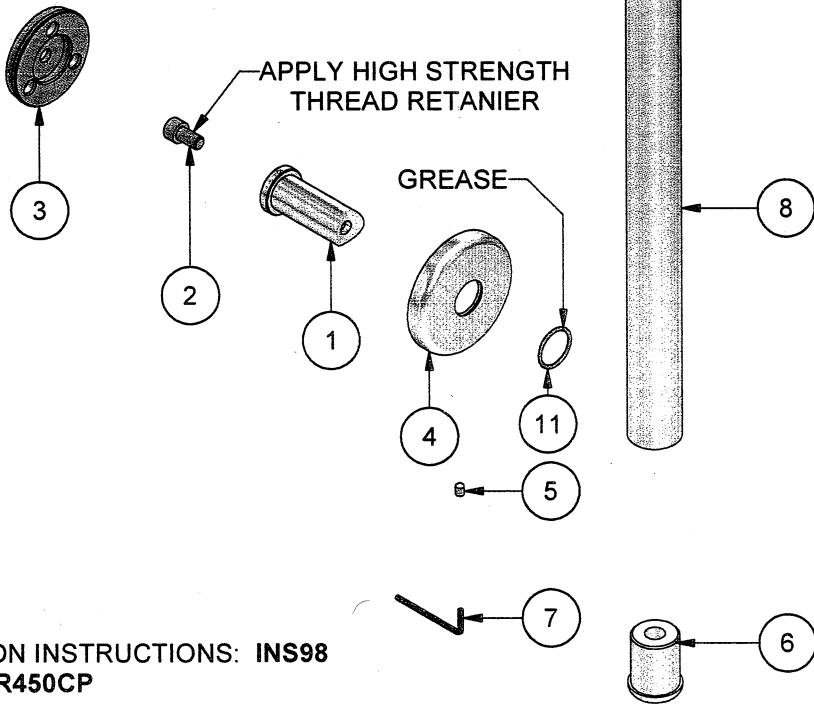

Parts List

| ITEM | QTY | PART NUMBER | DESCRIPTION | COMMENTS |
|------|-----|--------------|---|----------|
| 1 | 2 | BAS96CP | Grab Rail Base | |
| 2 | 2 | SCR75 | M8 x 1.25 - 16mm Long Hexagon Socket Head Cap Screw S/S | |
| 3 | 2 | RNG86 | Grab Rail Locking Ring | |
| 4 | 2 | WPL45CP | Grab Rail Wall Plate | |
| 5 | 2 | SCR29 | M5 x 8 Hex Socket Set Screw S/S | |
| 6 | 2 | SOC10CP | Grab Rail End Socket | |
| 7 | 1 | AKEY2.5 | 2.5mm Allen Key | |
| 8 | 1 | TUB120 | Grab Rail Tube (450) | |
| 9 | 1 | CARTBP7PLAIN | 560L x 140W x 105D Carton White | |
| 10 | 2 | SP9 | Park Grab Rail Foam Insert | |
| 11 | 2 | OR22X2 | O-Ring ID 22 x 2mm Wall | |

CONTROLLED

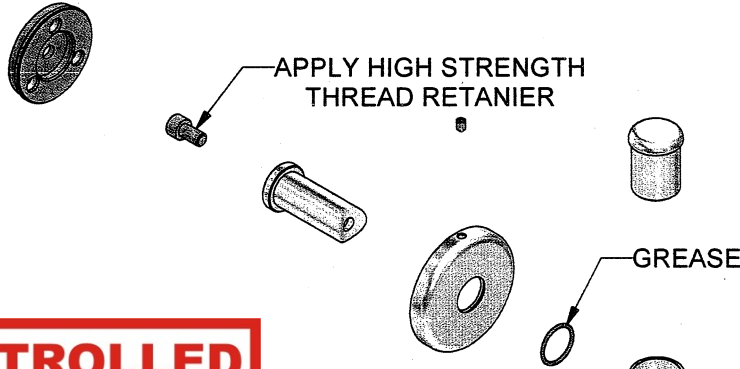

NOTE:

- 1. INSTALLATION INSTRUCTIONS: **INS98**
- 2. LABEL: **PKGR450CP**

| |
|---|
| Drawn by markd |
| Checked by |
| Approved by |
| Unspecified Tolerance X.XX = ± 0.05 XX.X = ± 0.2 XXX = ± 0.5 |

RAM
TAPWARE

RAMTAPS PTY. LTD.
556 Curtin Ave. East, Eagle Farm 4009.
Ph. (07) 3633 6000. Fax (07) 3633 6050.
© 2007 All dimensions in mm.
This drawing remains the property of Ramtaps and should not be copied or distributed without Ramtaps consent.

| | | | |
|---|--------------------------|-----------------------|--|
| File Name G:\WORK\Assembly\SHOWER DISABLED\PKGR450.idw | | | |
| Date Created 26/03/2008 | Design State Released | Client: RAM | |
| Title PARK GRAB RAIL 450 CENTRES | | | |
| Code: PKGR450CP | Edition 01 | Sheet 1 / 1 | |

